



USMC Civil Affairs School

0530 / 0531

Class 01-14

28 October – 22 November 2013

MGySgt Yntema

Marine Corps Civil-Military Operations School
Civil Affairs MOS Course

MCCMOS Admin



- We are here to support you in the following areas:
 - Lodging
 - Endorsements
 - Fitness Reports
 - Pros/Cons
 - Certificates
 - DTS questions

Lodging



Off base, you will receive:

\$88.00/ day for lodging and M&IE is \$56.00/ day.

Crossroads Inn, you will receive:

\$88.00/ day for lodging and \$11.70/ day for meals
Plus \$5/day for incidentals.

**A certificate of non-availability (CNA) will be required from Liversedge Hall in order to stay at the Crossroads Inn or off base

Lodging (Cont'd)



Liversedge, you will receive:

\$32.00 or \$42.00/ day for lodging and \$11.70 / day for meals plus \$5/day for incidentals

****Liversedge reserves the right to put Marines into any room depending on availability**

Endorsements



Off base, your statement will read:

“government quarters and messing were not available”

Crossroads Inn, your statement will read:

“government quarters was not available and
messing was available”

The barracks or Liversedge Hall, your statement will read:

“government quarters and messing were available.”

Endorsements (Cont'd)



Reporting/Detaching endorsements will be given on graduation day.

Your Certificate on Non-Availability (CNA) will be attached to your endorsement.

RC Marines



Fitness Reports (non-observed)

- Sgts and above:
RS- Capt Pevehouse, Michael S (last four: 8673)
- Capts and above:
RS- Maj Simon, Louis (last four: 6978)

Pro/Cons

- Cpls and below:
Pro/Cons will be issued by Small Group Leaders

Your Responsibilities



Today:

- Sign –in on computers
- Reporting endorsements
- Certificate of non-availability (if applicable)

After graduation:

- Take CA MOS course certificates to your local IPAC. YOUR IPAC must run you for the 0530/0531/0532 MOS. MCCMOS does not have that capability.

Important Numbers



- School OIC: Maj Simon
(703) 784-1356(w) / (951) 234-2263 (c)
- Operations Chief: MGySgt Yntema: Team 1A & 1B SGL
(703) 784-1114(w)/ (540) 287-0764 (c)
- Course Chief: MSgt Linares Team 2A & 2B SGL
(703) 784-2562(w)/ (703) 987-7882 (c)
- Senior Instructor: MSgt Cuoco: Team 3A & 3B SGL
(703) 784-2565(w)/ (732) 598-8731 (c)

Units Represented



- Estonian Army (LT Tsarski)
- I MEF, II MEF, III MEF CA Detachments
- Marine Corps Security Cooperation Group (MCSCG)
- Marine Corps Information Operations Center (MCIOC)
- The Basic School (TBS)
- Officer's Candidate School (OCS)
- I MEF (FWD)
- 1st CAG, 2D CAG, 4th CAG
- MCCMOS Staff

Medical / Dental



- The combined clinic is located at 3259 Caitlin Ave., near Lejeune Hall
- Sick call hours: 0730-0830 M-F
- Please advise your Team Chief
- Team Chiefs: Advise your SGL



Barber Gym



- Building 2073
Barnett Avenue
703.432.0590
703.784.2003
- **Hours of Operation:**
Mon-Fri: 0500-2000
Sat: 0800-1700
Sun & Holidays: 0900-1700
- Reflective Belt: Required aboard MCB Quantico at all times!
- Must have your ID to enter the facility



Gray Research Center



- Alfred M. Gray Research Center
2040 Broadway Street
Quantico, VA 22134
- Hours:
0730-1945 M-Th
0730-1745 F
1000-1745 Sat & Sun
Holidays: Closed



NMMC



- The museum is located on Hwy 1(South)
- Hours: 0900-1700 (every day except Christmas)
- Utilities are authorized



Out of Bounds



- Must fill out NAVPERS 1336/3 (back of classroom)
 - 'Special Request/Authorization'
 - 24 hrs or less: 80 miles
 - 24 hrs or more: (i.e. normal weekend: 300 miles).
- Do not wait until Friday (the sooner the better!!)
- Provide MSgt Linares with a printed route plan from Google Maps.

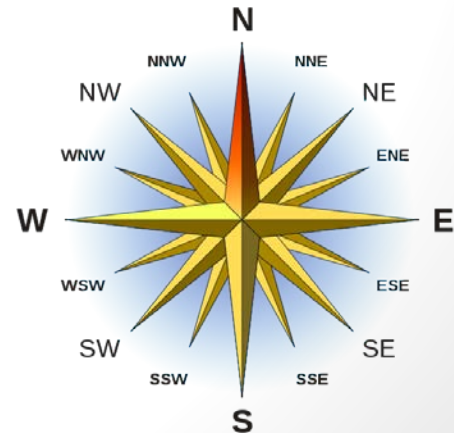

Detaching Endorsement



- Travel day is Saturday after Graduation
 - i.e., Saturday (23 Nov)

Pickup Certificates of
Non-Availability!!

Liversedge Hall: (703) 784-3149



Messing: Bruce Hall



- Bruce Hall (Building 2000)
- Hours are:
 - Breakfast: 0630-0800
 - Lunch: 1100-1245
 - Dinner: 1630-1800
 - Breakfast/Brunch: 0900-1100
 - Dinner/Brunch: 1630-1800

Messing: Other Options



- Food court at the Main PX
 - Hours: M-Sat 0900-2000 & Sunday 1000-1800
 - Commissary Hours: (Closed on Mondays)
T-F 0900-2000 (20 items or less 0700)
Sat: 0900-1900
Sun: 0900-1800
- “Q Town” also has several restaurants that can be frequented in utilities.

Messing: FEX



- Philippine Dinner: Wednesday 20 November approximately \$15/Student
- MGySgt Yntema will collect this money (from each team chief only) on Friday 8 November
- Remaining meals during the FEX will be MREs which will be deducted from your pay

Classroom Rules



- Drinks need to be in a cup with a lid to prevent spillage
- Cell phones need to be placed at back table during class
- Food is not permitted in the classroom unless authorized
- Designated smoking area: Outside the doors on the right side of the classroom. Only Cigarette butts in the container (NO TRASH)
- Dipping is authorized in class (Keep a lid on it)
- **Coffee mess and daily classroom cleanup is your responsibility:** Each group has the coffee mess & clean up responsibilities for one week
 - Week One: Teams 1A & 1B
 - Week Two: Teams 2A & 2B
 - Week Three: Teams 3A & 3B
 - Week Four: at Camp Upshur for the FEX
- **Be on time!! (TRAFFIC HERE IS POOR AT BEST)**

Computers



- This classroom is equipped with both NMCI and Comcast ports in the floor.
- **DO NOT PLUG YOUR PERSONAL LAPTOPS INTO THE PORTS MARKED "NMCI"**
- **DO NOT PLUG YOUR NMCI LAPTOPS INTO THE PORTS MARKED "VENDOR"**
- If you are not sure, ask a staff member for assistance

MCCMOS: Bldg 3094

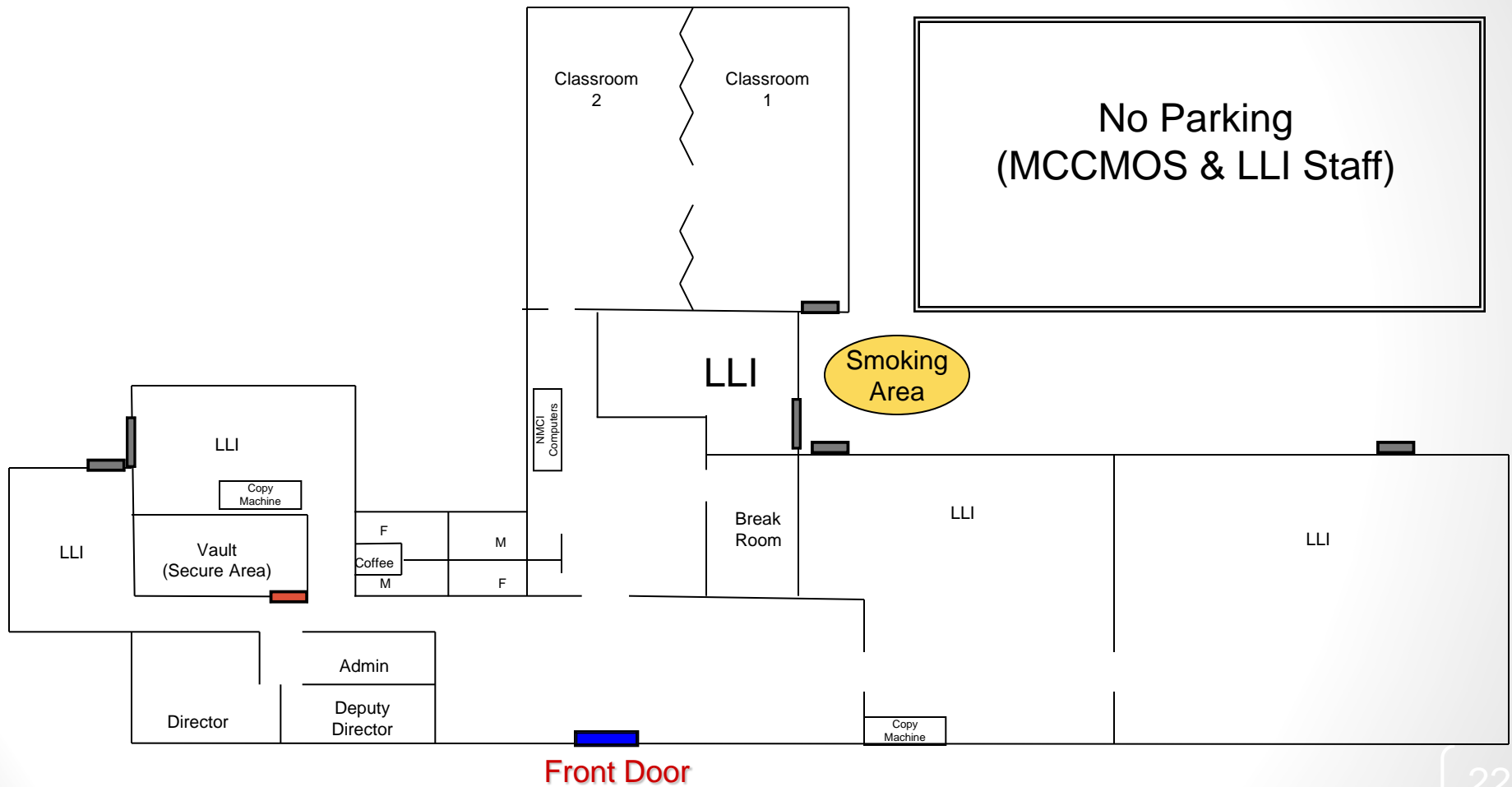

Inclement Weather



- <http://www.quantico.usmc.mil/OPM/?m=Weather>

WDQUAN423072 Unclassified

http://www.quantico.usmc.mil/OPM/?m=Weather - Microsoft Internet Explorer provided by NMCI

http://www.quantico.usmc.mil/OPM/?m=Weather

File Edit View Favorites Tools Help

http://www.quantico.usmc.mil/OPM/?m=Weather

Home Contact RSS Feeds

MARINES
THE FEW. THE PROUD.
MARINE CORPS BASE QUANTICO

HEADQUARTERS :: RECRUITING :: UNITS :: CAREER :: MARINE ONLINE :: MARINE 4 LIFE :: FAMILY :: PUBLICATIONS :: LOCATOR :: MCCDC :: TECOM

SITE NAVIGATION

- Marines.mil
- MCB Quantico Home
- New Personnel
- MCBQ Tenants
- MCBQ Activities
- Base Information
- Public Affairs
- Base Commander
- Weather
- LAN Messages
- Directive System
- Quantico MCCS
- Base Theater Movie Schedule
- Marine Corps Marathon

MARINE CORPS BASE QUANTICO

Site Search

Print Page | Bookmark | E mail

Current Base Operating Code

Code:	Code Green
Base Opens (Time):	Normal
Base Closes (Time):	Normal

Currently: Monday, January 10, 2011 8:37:59 AM

DoD School Closure / Delay

School Opens (Time):	Normal
School Closes (Time):	Normal

Base and Local Area School Closure & Operations Information Resources

Base Operating Condition color codes giving Base closure and personnel reporting status are announced as determined by Base Operations.

Official updates to the Base Operating Condition and Base school closure and delay announcements (normally during the winter months) are disseminated via:

- the MCB Quantico Hotline at: **703-784-3638**
- the [MCB Quantico Mass Notification System](#)

Updates to weather conditions, base operations and school closings and delays are passed to the following TV and radio stations:

Cable TV Channels

- TV 4 - WRC - (NBC) Washington
- TV 5 - WTTG - (FOX) Washington
- TV 7 - WJLA - (ABC)

Current MCB Quantico Weather and Forecast

The Meteorological Section at MCAF (station KNYG) aboard MCB Quantico is an official forecasting/observation station for the National Weather Service. Their observations are made 24/7 and serve as a valuable component of our national weather network.

[Present Moon Phase](#) [Present Worldwide Daylight & Darkness](#) [Timezone Map](#) [Dynamic Graphical Forecast, CONUS](#)

Operating Code Procedures

Winter has arrived in Northern Virginia. To ensure the safety of all aboard MCB Quantico, the base commander has established procedures for evaluating weather conditions to determine a delayed base opening or early base closure and how to publicize those decisions to all affected personnel. *It is important that all personnel understand and heed these procedures.*

Upon first indication of possible inclement weather, command personnel begin monitoring weather conditions regularly to determine potential impact upon base operations. As inclement weather nears or begins, the command monitors weather reports more frequently and begins to receive regular road condition reports from aboard base and in the surrounding community. Command personnel also communicate with local civilian authorities and the federal government concerning their assessments of the weather conditions.

Based upon the type and volume of expected precipitation, other conditions and the capabilities of base equipment and personnel to keep the roads clear and safe for travel, the commander will make the decision to keep the base open, delay base opening, or close the base.

Academics



- There will be three tests. Testing will be conducted on the mornings of 30 October, 1 November, and 6 November. Planners will have one additional test on Monday 18 November.
- Minimum standard is **80%**
 - **If your GPA is not 80% or above on the last test you will not receive the appropriate MOS designator.**
 - **Counseling sheets will be completed later this afternoon.**

Academics (0531)



- Exam 1
- Exam 2
- Exam 3
 - 3 Exams = 40% of total grade
- 8 Performance Evaluations = 60% of total grade
- Minimum Standard on exams **80%** (max score on retest is 80%)
 - Retest grades (if necessary) are recorded "as is" if under 80%
- All events are weighted into overall GPA

Academics (0530 & E-7)



- Exam 1
- Exam 2
- Exam 3
- Exam 4
 - 3 Exams = 60% of total grade
- 11 Performance Evaluations = 40% of total grade
- Minimum Standard on exams **80%** (max score on retest is 80%)
 - Retest grades (if necessary) are recorded "as is" if under 80%
- All events are weighted into overall GPA

Team Gear



- All team chiefs will sign for their respective team's gear at COB 28 October. This gear includes:
 - 1 Digital Camera/team
 - 2 Non-NMCI laptops with accessories
- MSgt Cuoco will issue the equipment along with ECR cards for the gear.

Welcome Aboard



Questions?

